



Love their  
**STYLE?**

THE SCAVOLINI FLUX UNITS  
ARE FROM STONES AND TOOLS  
£££. FOR SIMILAR, TRY THE  
ASTRAL BLUE AT MAGNET ££  
OR THE PACRYLIC BLUE  
QUARTZ AT WREN  
KITCHENS £

*Retro flavour*

It wasn't just the teal blue  
colour that made Melissa  
and Marc fall in love with  
the units, it was the subtle  
curves they have, too



**BEFORE**



# 'It's bursting with colour'

If you love colour and modern lines, look at Italian kitchens - the Pressingers love theirs

FOR WHERE TO BUY ITEMS SHOWN, TURN THE PAGE



**F**aced with a house that hadn't been decorated for 30 years, Melissa and Marc Pressinger saw it more as an opportunity than a challenge. In the kitchen, it meant they could start from scratch to create the perfect space to suit their family life. 'Our kitchen is the nerve centre of our home, where we eat together but also where our boys do homework and play,' says Melissa. To get more space, the couple sacrificed a cloakroom and an old boiler room, which were located just beyond the old kitchen. They also stole space from the hall to create a walk-in pantry and laundry cupboard. As far as the style of the new kitchen went, Melissa and Marc were keen on Italian design - so when friends recommended the range by Scavolini, it didn't take long for the couple to fall for its Flux design. 'We loved the combination of curved and straight lines,' says Melissa, 'but it was the blue colour that clinched the deal. And we didn't stop there - we added splashes of yellow and red to brighten up the scheme even more.'

**TURN OVER TO FIND OUT HOW**  
*the Pressingers created their new kitchen*

## Take the **60-SECOND TOUR**

### THE PROPERTY

A five-bedroom, detached, Thirties house in Bushey Heath, Hertfordshire, bought in 2012.

### WHAT IT COST

Units.....	£13,500
Worktops and splashbacks.....	£4,000
Sink and taps.....	£729
Appliances.....	£4,025
Flooring.....	£1,300
Lighting.....	£195
Blinds.....	£250

Table and chairs.....£454  
**TOTAL.....£24,453**

### WHO LIVES HERE

Melissa and Marc Pressinger, with their two sons, Joe, seven, and Sam, five.

### WHAT THEY DID

Knocked through to an old boiler room and cloakroom at the end of the kitchen to create a larger space and to add patio doors to the garden. The couple also stole

space from the hall to create a walk-in pantry and a cupboard for the washer and dryer.

They ripped out the kitchen and installed new units and some new appliances.

### THE LOOK

Retro, with shapely units and bold, bright colours.

### LESSONS LEARNED

**“We have a boiling water tap, which is great for tea and also comes in handy when I need to soak my pots and pans in boiling-hot soapy water.”**

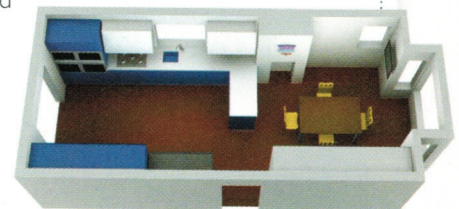

### THE LAYOUT

The fridge-freezer is to the left of the door that leads to the hallway, followed by a walk-in pantry and a cupboard that houses the washing machine and dryer. Opposite these are the ovens, hob and sink. In the dining area, there is a bank of units that provides more storage



**Top table**

Melissa found the table on Gumtree for £100 and gave it a couple of coats of wood stain to update it



**Walk-in pantry**

The couple stole space from the hall to create a large larder

*Where to buy*  
**ITEMS SHOWN**

Scavolini Flux **kitchen** in Alaskan Blue and White, from £300 for a 600mm base unit; Evolution bank of **units** (in dining area), £2,115; White Prisma Bianco quartz **worktop** and **splashbacks**, from £425 per linear m; all Stones And Tools. IQ-300 HB43AB550B **ovens**, £699 each; HB84E562B **microwave**, £690; bean-to-cup **coffee machine**, £1,279; IQ-700 ER926SB70E **hob**, £658; all Siemens range; Grohe Minta **tap**, £240; Insinkerator **hot water tap**, £349; Pyramis **sink**, £140; all Such Designs. For a similar **fridge-freezer**, try the RFAA52S, £319, John Lewis. Roble Cognac **floor tiles**, £64.73 per sq m, Porcelanosa. **Pendants**, £65 each, Frandsen range, Innes. Element Pure Red **blinds**, from £23.95 for a W30cm x 30cm drop, Tuiss. DSR Eiffel **chairs**, £59 each, Cult Furniture. Diner **sign**, £700, eBay. For a similar **table**, try the Kris, £1,835, Heal's. Retro **bin**, £92, John Lewis. **Kettle**, £38.99, Morphy Richards. Novo **canisters**, from £15.37 each; Deco Peacock **tea towels**, £17.99 for three; Deco Peacock **oven glove**, £12.99; Minerva **mugs**, £6.46 each; all Typhoon range, Amazon.co.uk

**How we did it**



“ We discovered the boiler room was full of asbestos, so the building work was put on hold for 10 days until the asbestos removal company could come. Luckily, we were staying at my parents’ while the work was happening. Our builders were amazing, and knocking down the wall at the far end of the room and stealing space from the hall, plus putting in patio doors, cost around £3,000. When the builders were finished, the kitchen company came and measured up and helped us decide on the layout. The kitchen company also provided the fitters, and installation of the units and appliances cost £4,500. Our builders then did all the decorating, which came to around £2,500. It all took about five months, but that was because it was



**Play area**

On one wall in the dining area is a blackboard and units that store all